

DIY CLUBHOUSE PLAY SET

WITH 5' SLIDE



Materials

10 – 4" x 4" x 8' wood	1 – 4" x 4" x 10' wood	8 – 2" x 6" x 8' wood
44 – 2" x 4" x 8' wood	17 – 1" x 4" x 8' wood (14 optional)	8 – 2" x 2" x 8' wood
12 – 5/8" x 5 1/2" x 6' cedar fence pickets	2 – box cedar shingle siding (optional)	40 – 3/8" x 6" carriage bolts, flat washers and nuts
2 – 1" x 3" x 8' wood	3 – sheets T1-11 plywood siding	1 gate hinge kit
5 foot turbo tube slide	1 hour DIY swing kit	3 – plastic climbing rock kits
1 plastic telescope	1 plastic steering wheel	Paint primer/Exterior paint
2 1/2", 1 5/8" exterior screws	brad nails	Stain/Sealer

Cut List

Quantity	Material	Length	Notes
10	2x4	93"	
2	2x4	93"	45 deg miter 2 ends
4	2x4	62 ¾"	See ladder
4	2x4	58 ½"	
2	2x4	55"	
8	2x4	48"	
2	2x4	48"	45 deg miter 2 ends
2	2x4	47 ½"	
2	2x4	41"	
10	2x4	41"	45 deg miter 1 end
4	2x4	36"	
3	2x4	34 ½"	
1	2x4	32"	
1	2x4	31 1/8"	45 deg miter 2 ends
2	2x4	25"	
18	2x4	24"	
2	2x4	23"	
7	2x4	21"	
5	2x4	13 ½"	
2	2x4	8 ½"	45 deg miter 1 end
1	2x6	67"	
4	2x6	48"	

Plywood siding cut to fit, for a cheaper option use 1x4's.

Quantity	Material	Length	Notes
1	2x6	34 ½"	
12	2x2	36"	
1	2x2	32"	
2	2x2	16 ½"	
4	2x2	6"	
14	1x4	73"	optional
2	1x4	41 ½"	
2	1x4	23"	
2	1x4	20 ½"	
2	1x3	26"	
2	1x3	21"	
4	1x3	16 ½"	
3	½" x 5 ½"	48 ½"	cedar
2	½" x 3 ¼"	48 ½"	cedar
6	½" x 5 ½"	23"	cedar
4	½" x 5 ½"	16"	cedar
4	½" x 5 ½"	20 ½"	cedar
2	½" x 4"	19 ½"	cedar
4	½" x 5 ½"	4"	cedar
6	½" x 2 ½"	26"	cedar
4	½" x 2 ½"	8 ½"	cedar

Step 2

Layout the 2 walls, spacing the 4x4's as noted. Make sure the walls are square and bolt each joint together with 2-3/8" x 6" bolts, washers and nuts. Stand the walls up and space with 48" 2x6's, square up the walls and bolt together with 3/8" x 6" bolts.

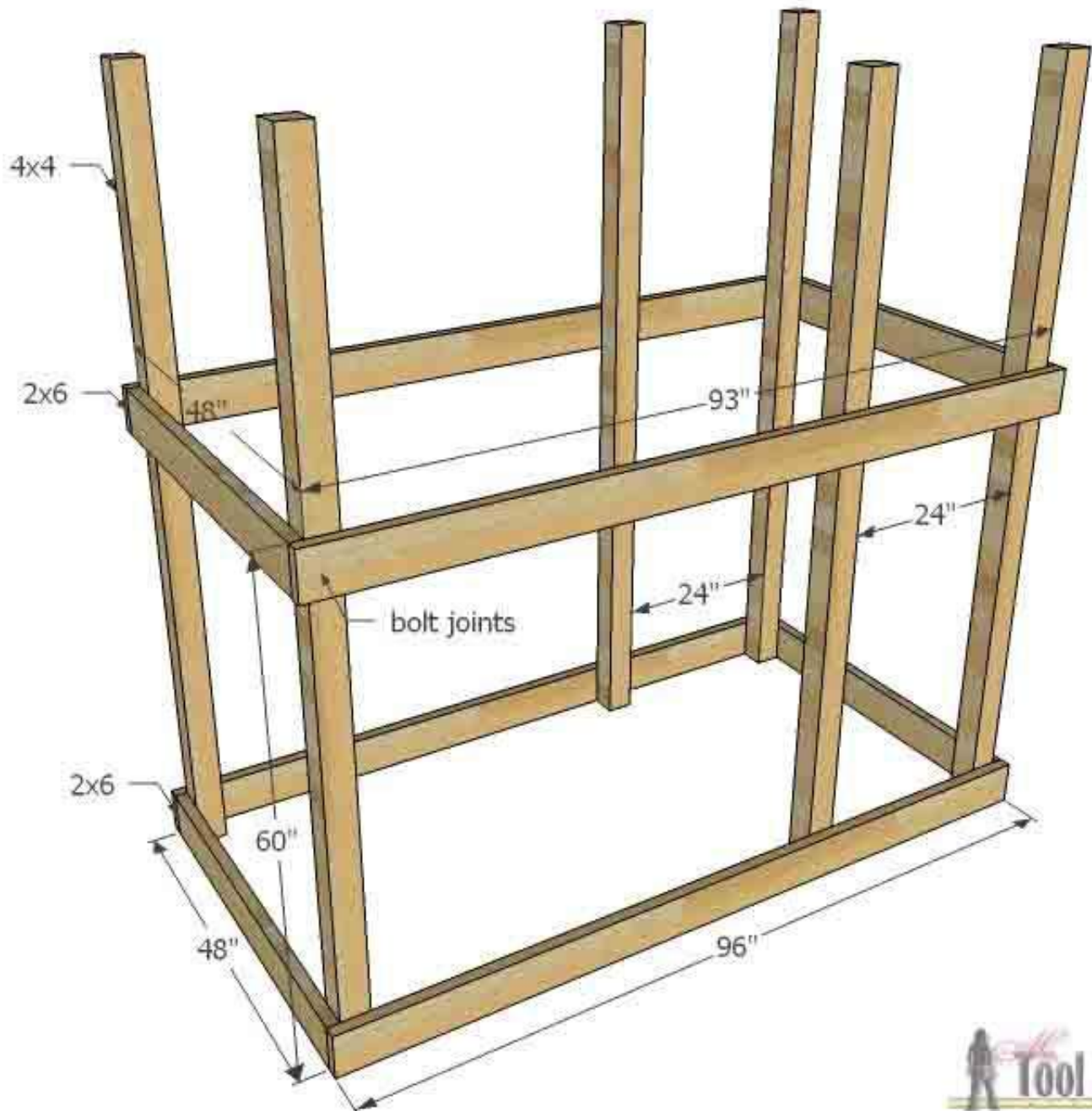

Step 3

Measure and mark down 1 1/2" from the top of the 2x6's. Install the floor joists, spaced approx. 16", with 2 1/2" screws or nails.



Install the floor boards. Secure the floor boards with 2 1/2" screws or nails, leave about a 1/2" gap between the boards.

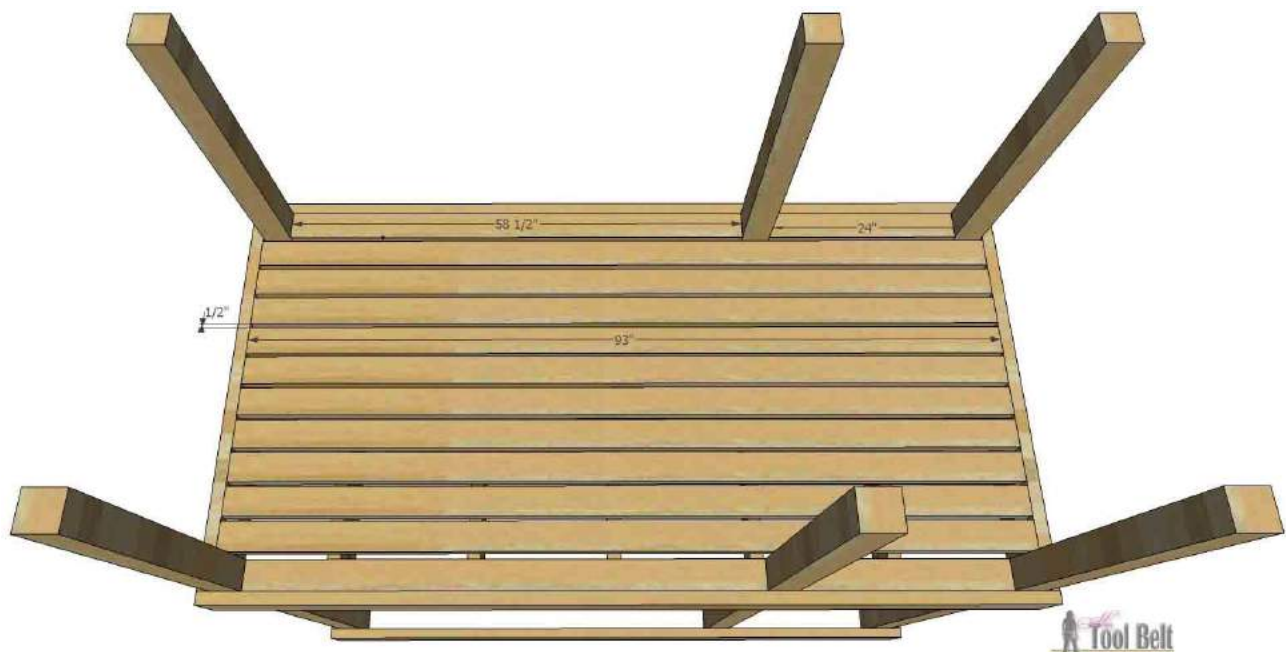

Step 4

Add the framing for the 5 foot slide, each slide model may vary see slide instructions.

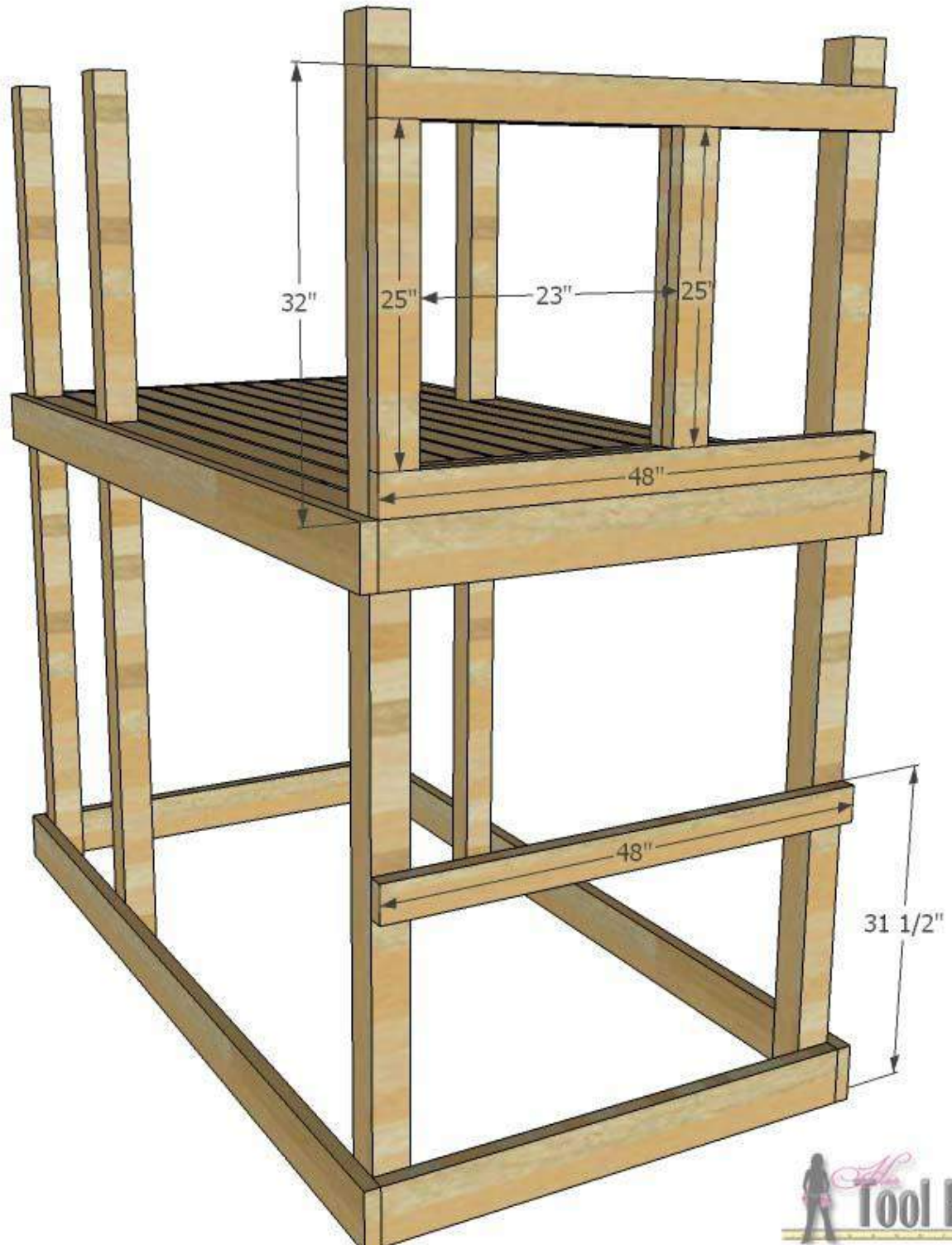

Step 5

Add framing for windows as noted, use 2 1/2" screws or nails to secure in place.

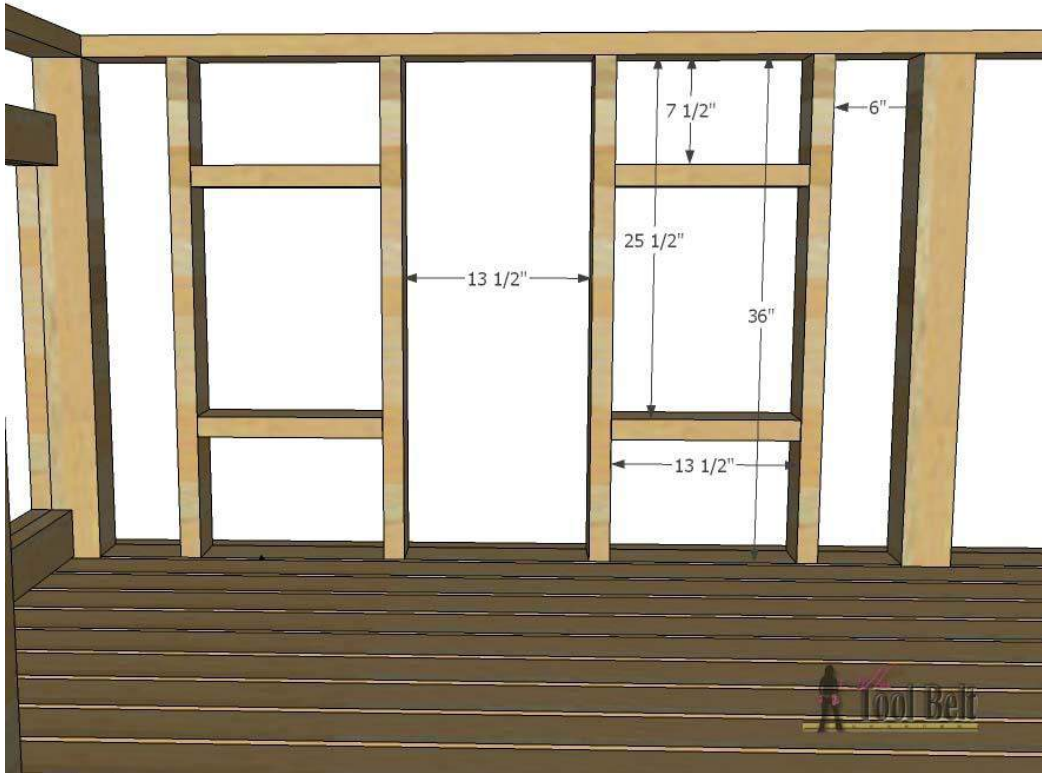

Cut railing with 45 deg miter cuts on each end, secure to 4x4 posts and window framing with 2 1/2" screws or nails. Add 2x2x32" and 2x4x36" frame pieces.

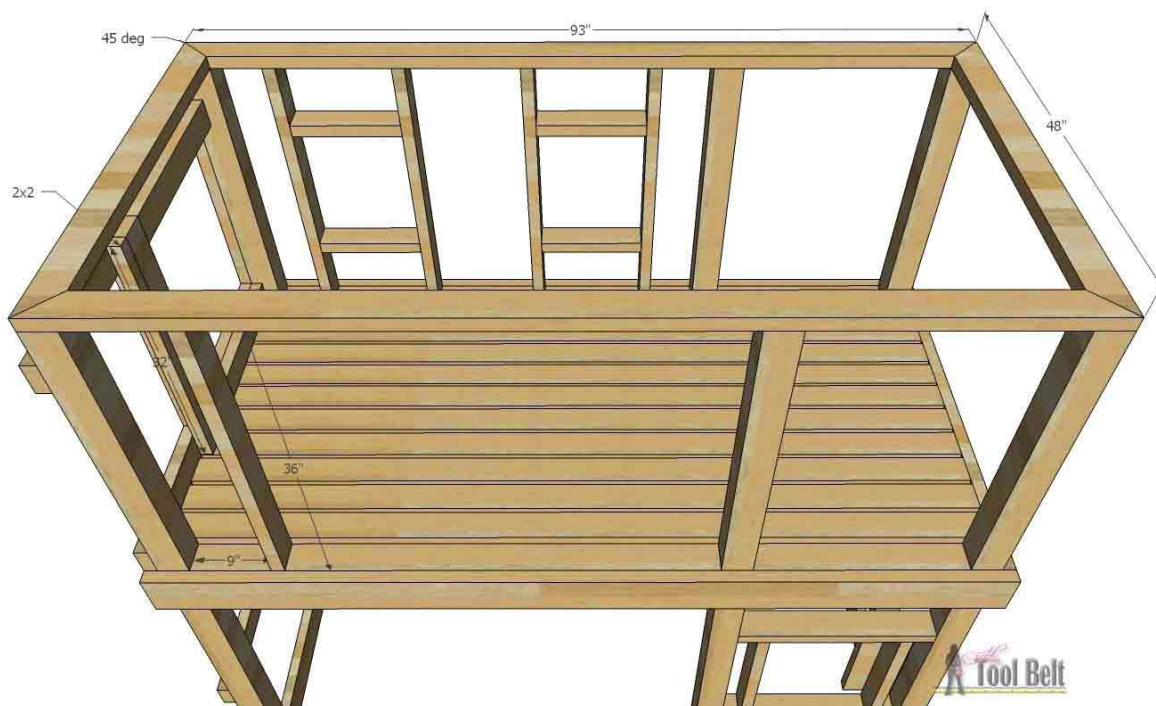

Frame in the large window in the front, secure with 2 1/2" screws or nails.

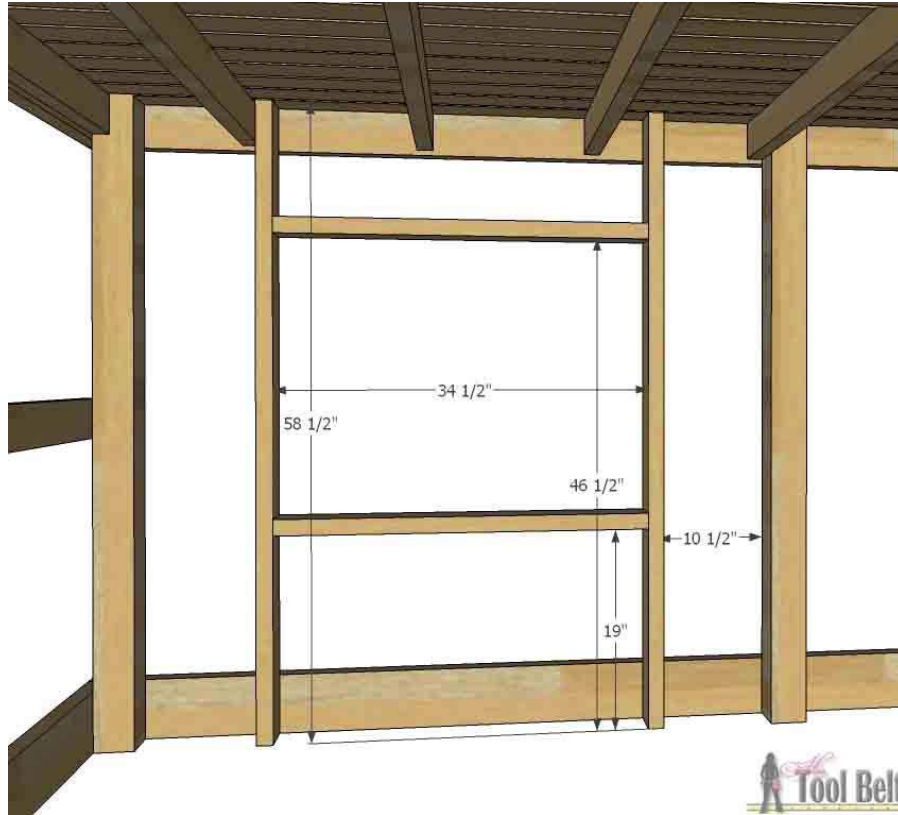

Frame in the back corner window and wall support. I used pocket holes on the 24" pieces for ease of installation.



Step 6

Create the roof rafters. Cut 10 – 2x4's that are 41" long and have a 45 deg miter cut on one end. On 8 of the boards, cut a birds mouth and seat. This can be easily done by lining up the boards and clamping them together. Mark $30\frac{1}{8}"$ and $32\frac{7}{8}"$ from the short side of the 45. On a circular saw, set the blade length to 2" and angle at 45 deg. Gang cut the rafter pieces. Attach the rafter boards to the 2x6 with $2\frac{1}{2}"$ screws or nails.

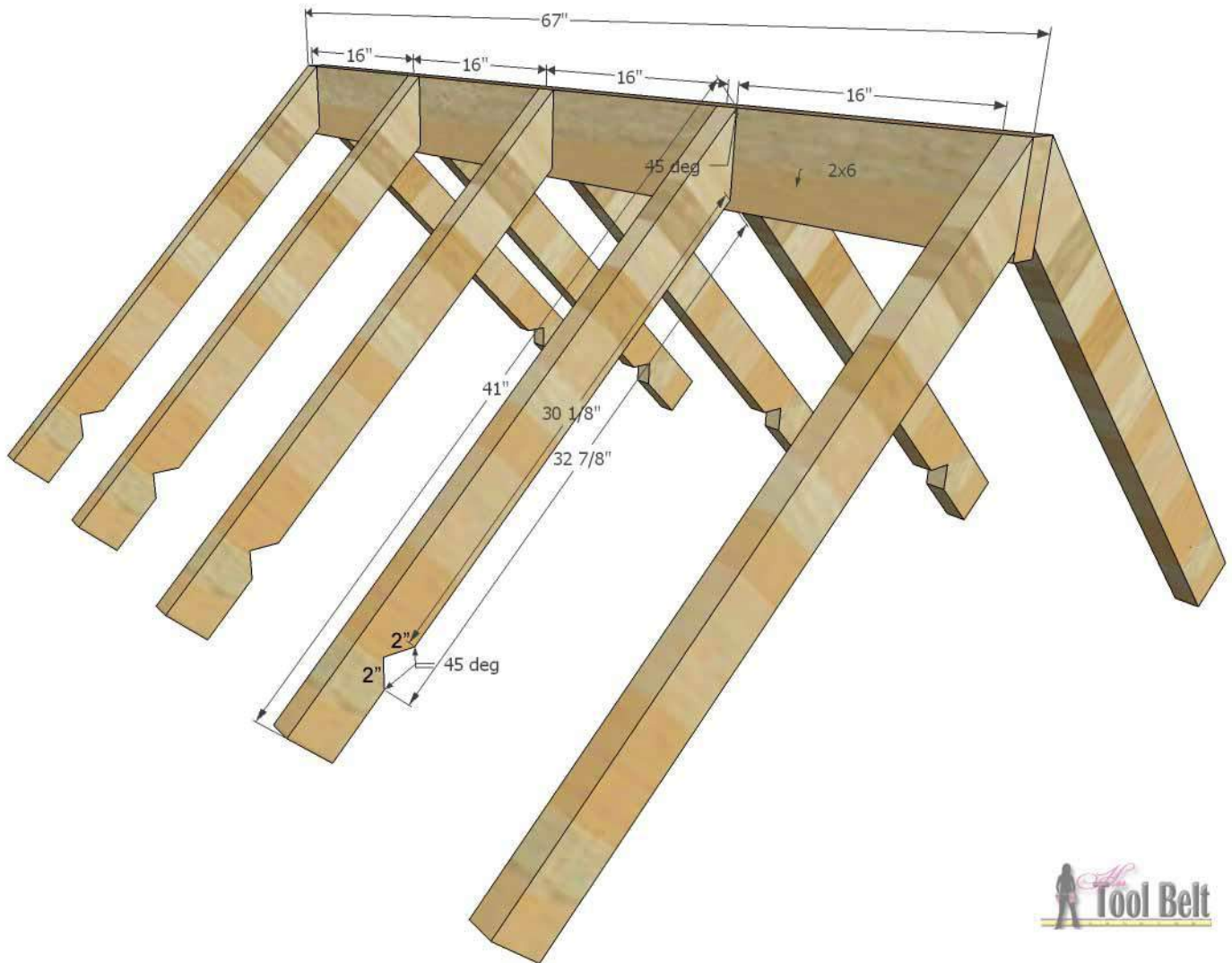

Secure the rafters to the railing with $2\frac{1}{2}"$ screws or nails. The front rafter will butt up to the railing, screw into the railing. Add additional support as necessary.

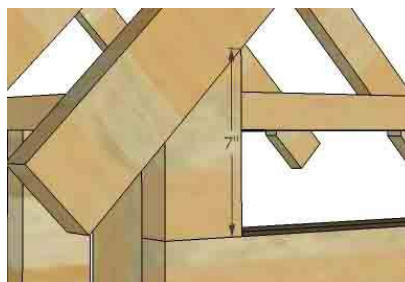

Step 7

There are a number of different options for the roof. I decided to splurge and do cedar wood shingles, because I like the look. To install the shingles, you need to install lath, use 1 5/8" exterior screws or 2" nails. Install the wood shingles according to the instructions.



Step 8

Add decorative beams to the front of the roof, use 2 1/2" screws to secure into place.

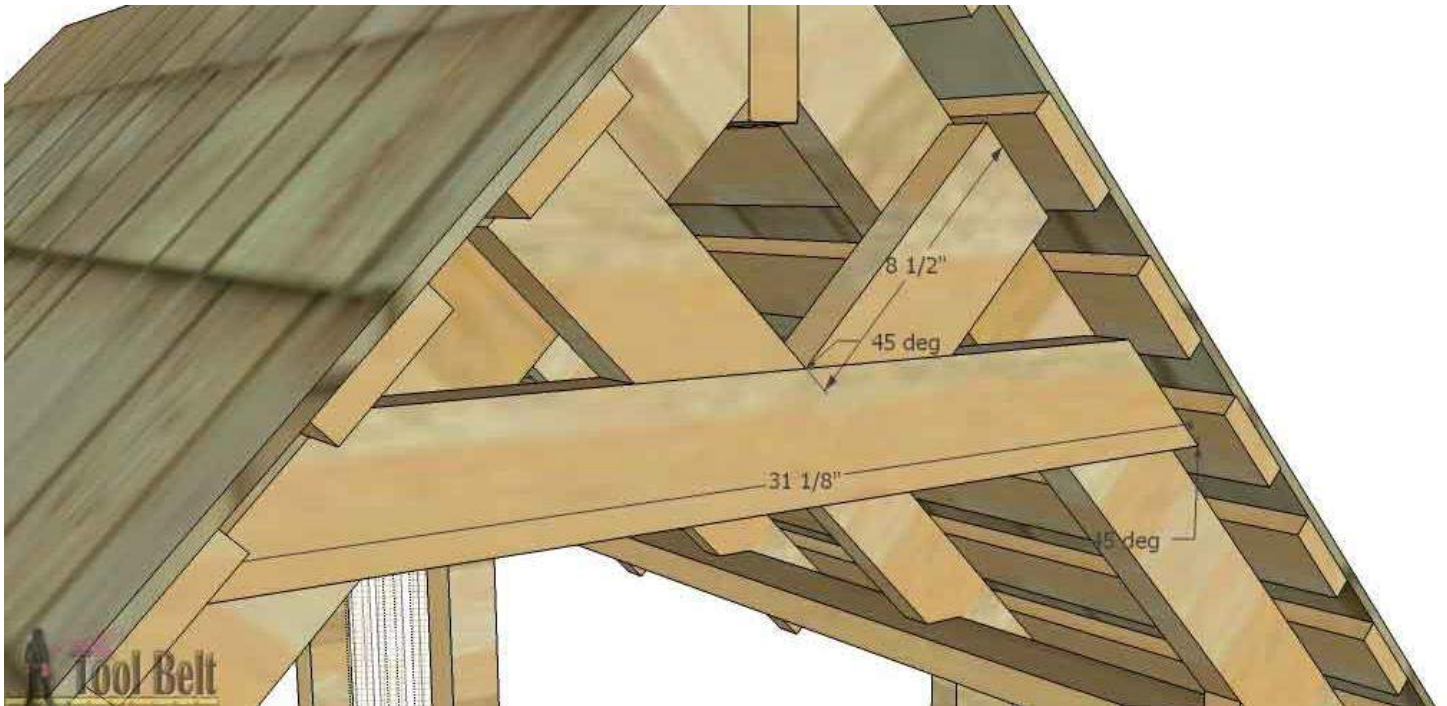

Step 9

Install the railing balusters as noted; secure the ends with 2 1/2" screws.

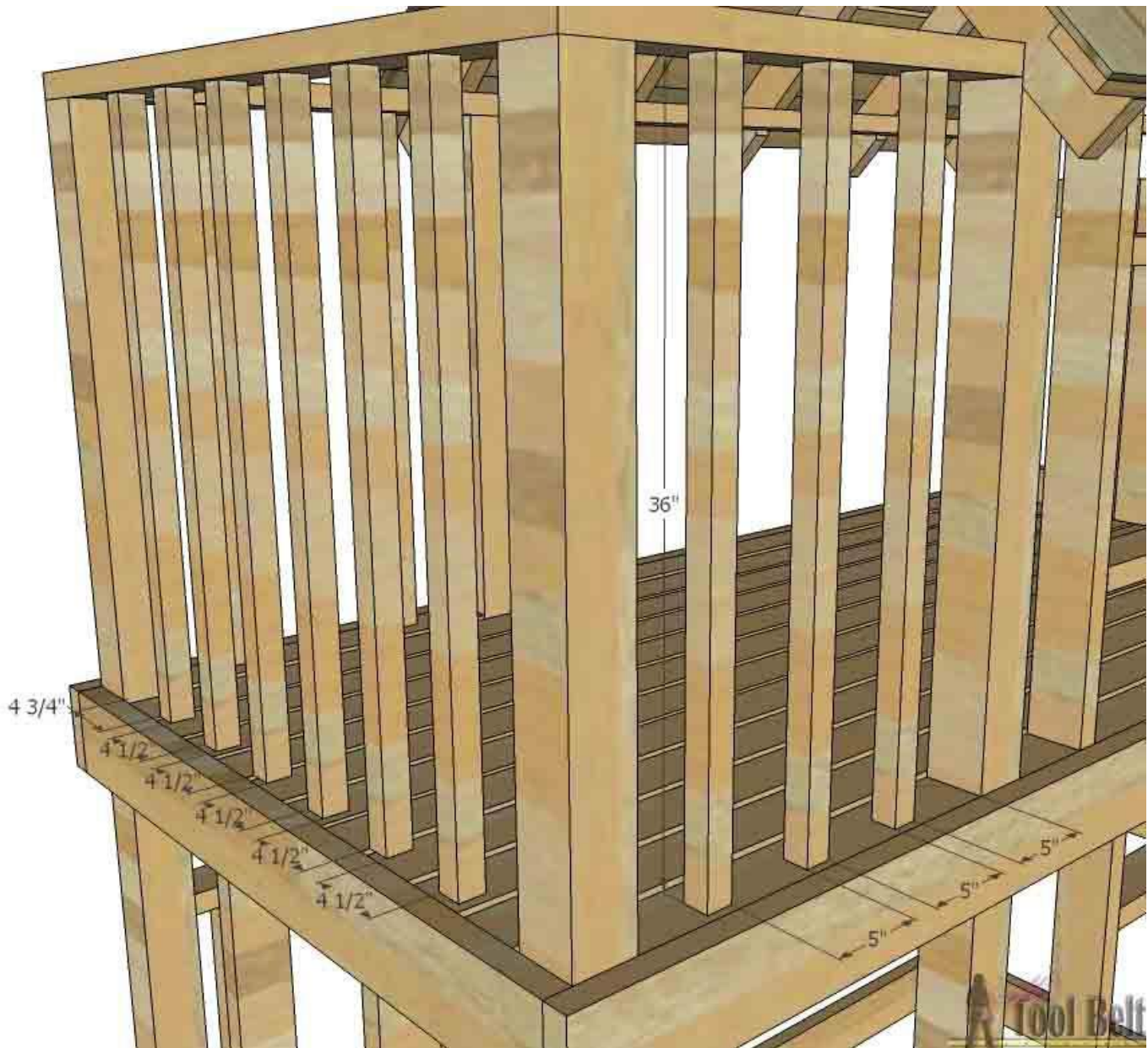

Step 10

Cut 4 of the ladder sides (2 for the ladder, 2 for the climbing wall). Measure and mark 1" from a side, make a cut on the miter saw at 15 deg (have someone assist holding the board perpendicular to the saw.) Make another 15 deg cut on the end as noted. Measure down 62 1/8" and make another 15 deg cut. For the ladder, mark every 11" from the bottom on the front and back (this will give you marks to line up the treads, so they are horizontal. Secure the treads into place with 2 1/2" screws.

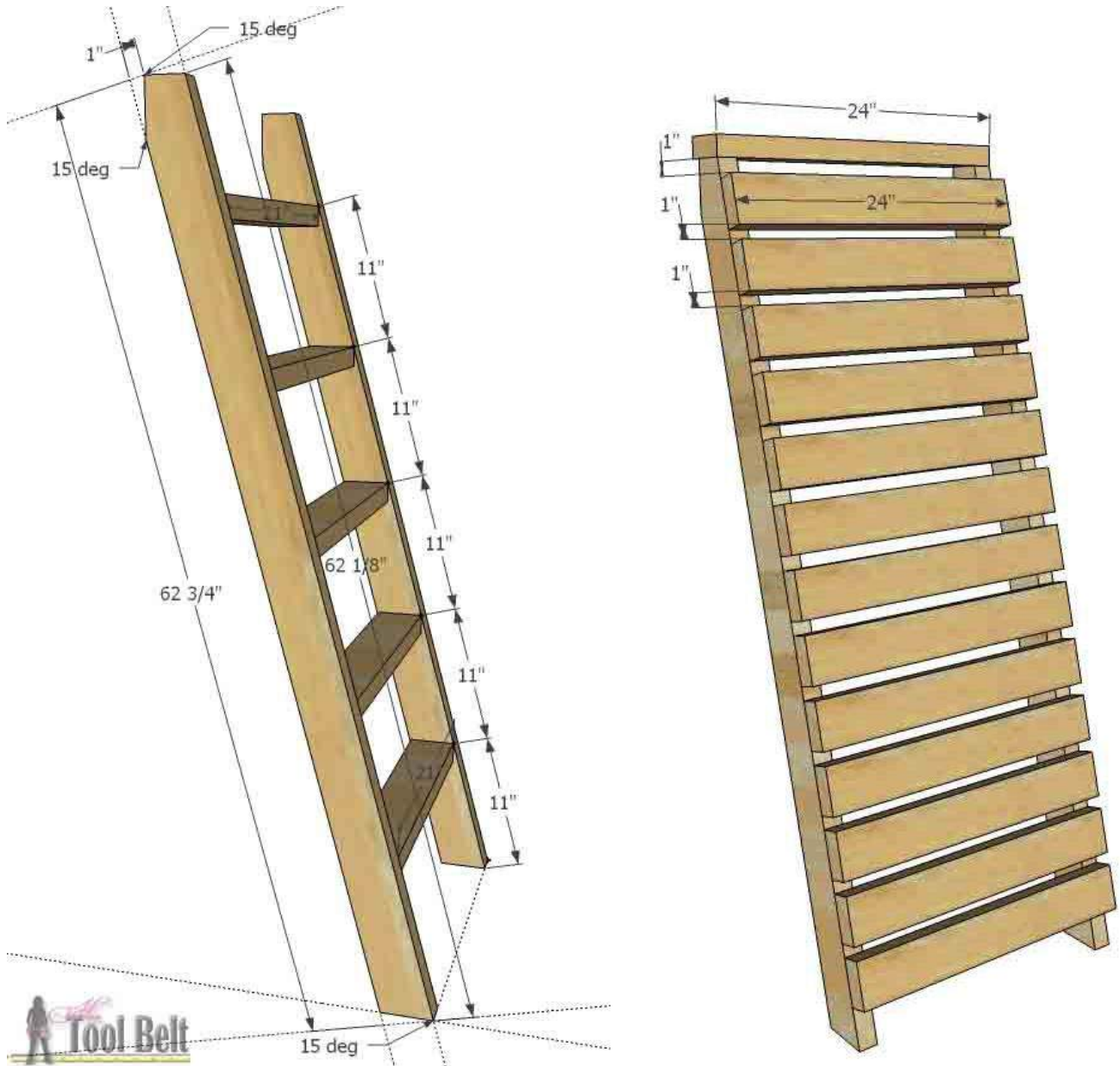

The climbing wall slats can be made from 2x4's or 1x4's depending on the plastic climbing rock instructions. Space the slats every 1" and secure with 2 1/2" screws. Install the plastic climbing rocks according to the instructions. Attach the ladder and climbing wall to the playset with 2 1/2" screws.

Step 11

I used T1-11 plywood siding for walls; a cheaper option would be 1x4's. Double check the siding measurements with your framed playset, make adjustments as necessary. Cut the panels, then place on the playset and trace the window locations. Use a circular saw or jig saw to cut out the windows. Secure the siding panels onto the playset with 1 5/8" exterior screws.



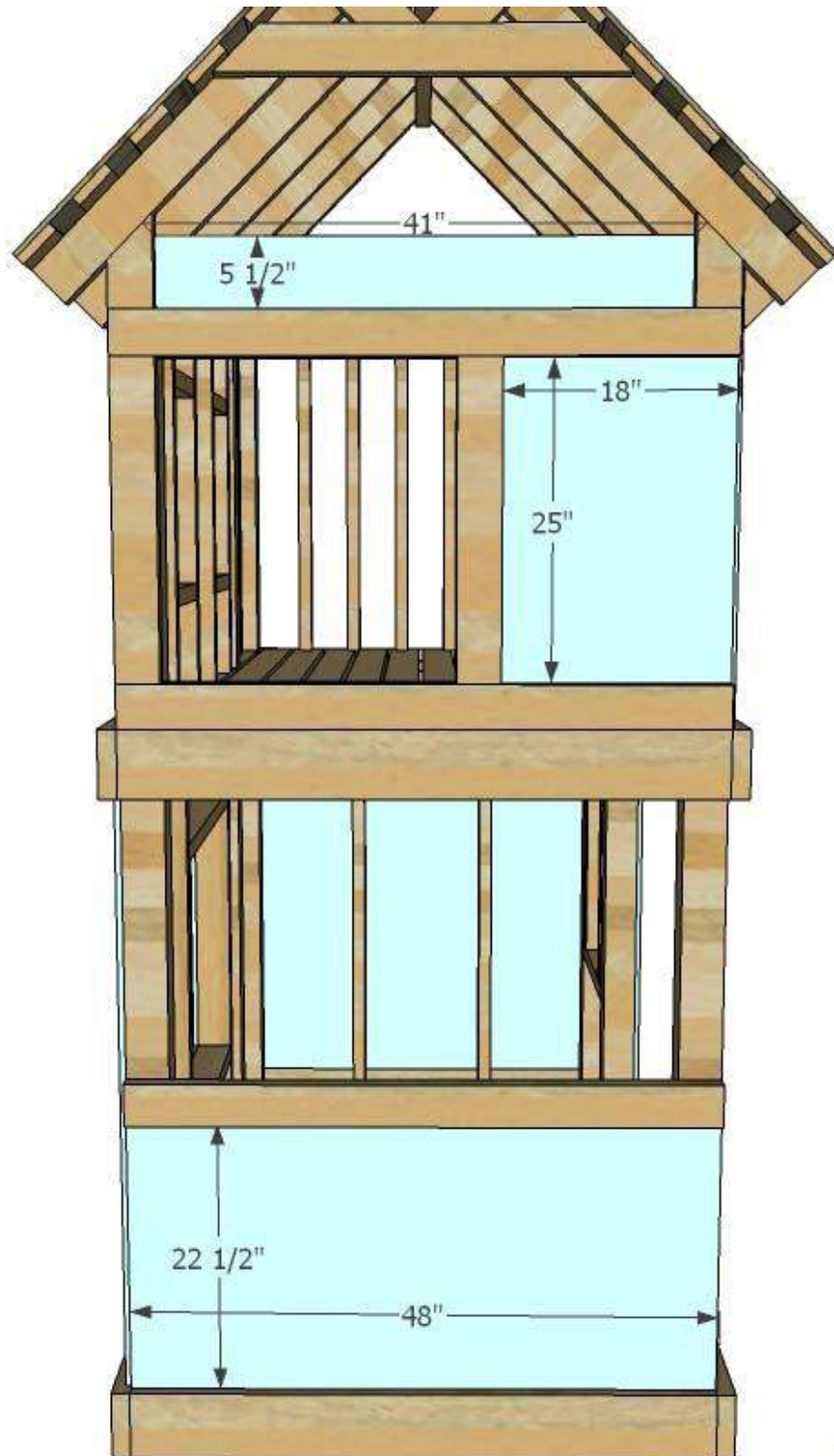



Step 12

Add trim to the windows, use screws or 2" brad nails to secure into place.

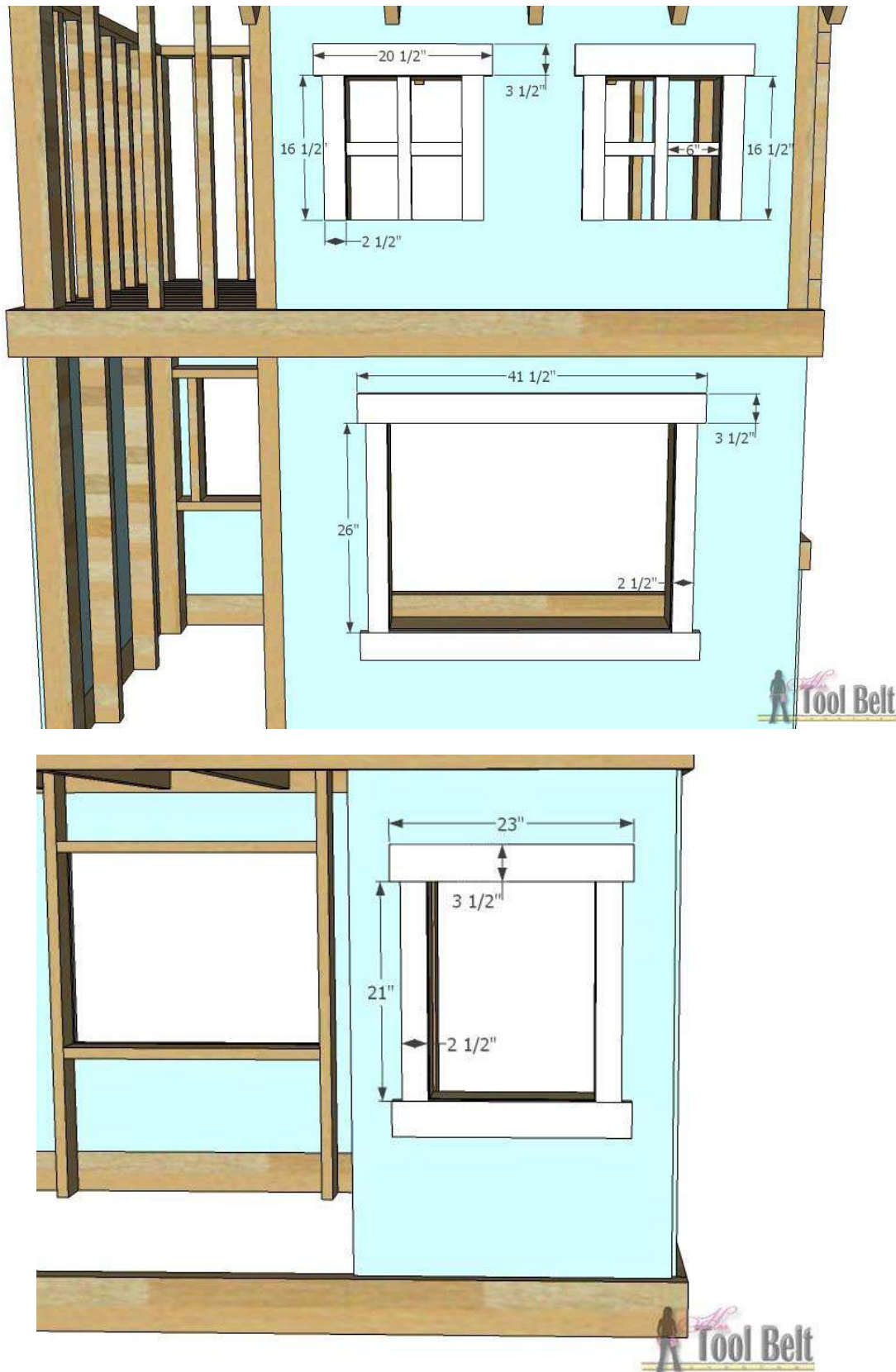

Step 13

Build the door from cedar fence pickets, cut the inside panel.

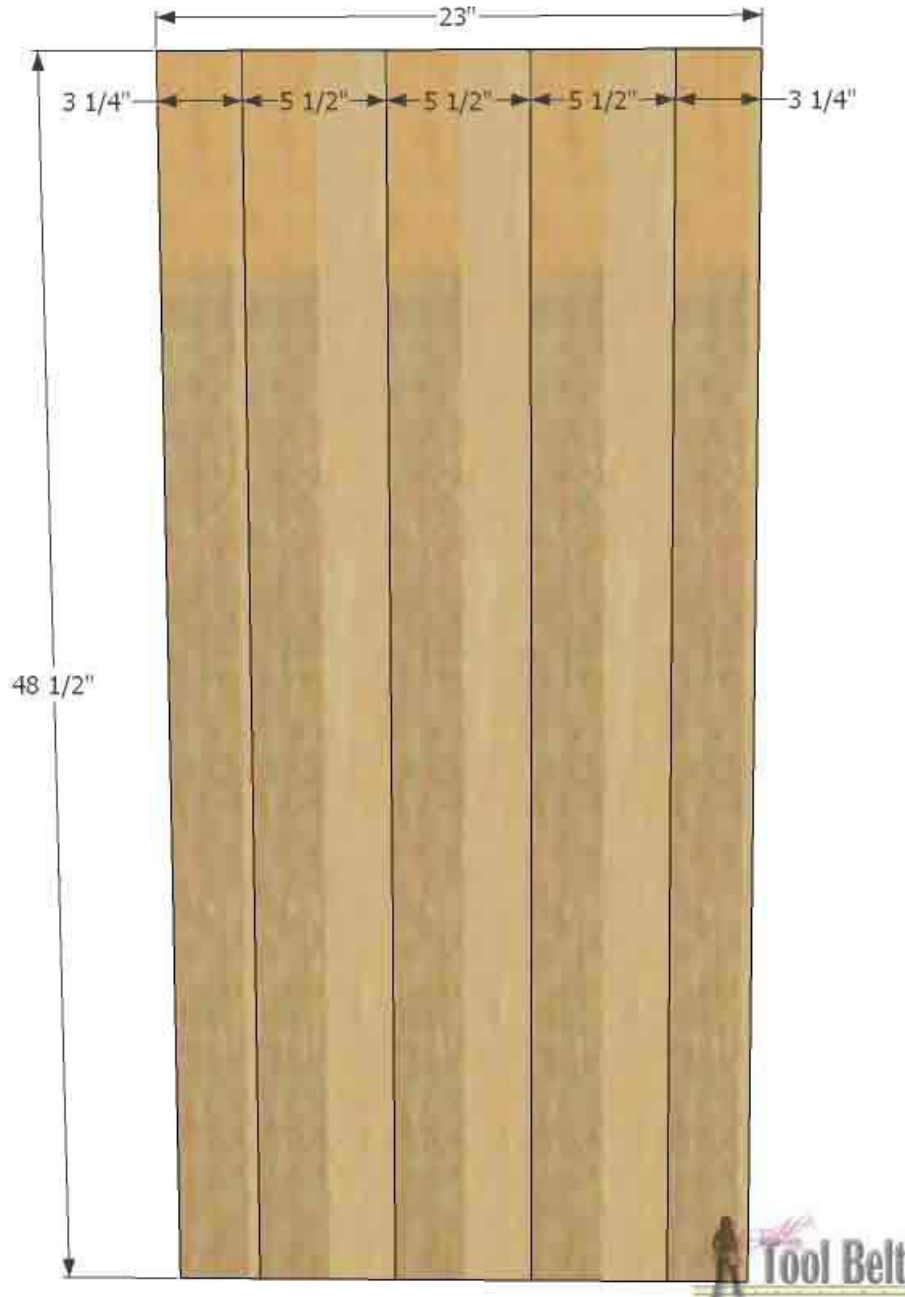

Attach a top, middle and bottom piece to the front and back, secure with 1 5/8" screws. Add side trim to the front with 3/4" or 1" brad nails. Attach gate hardware hinges to the door and attach to playset.

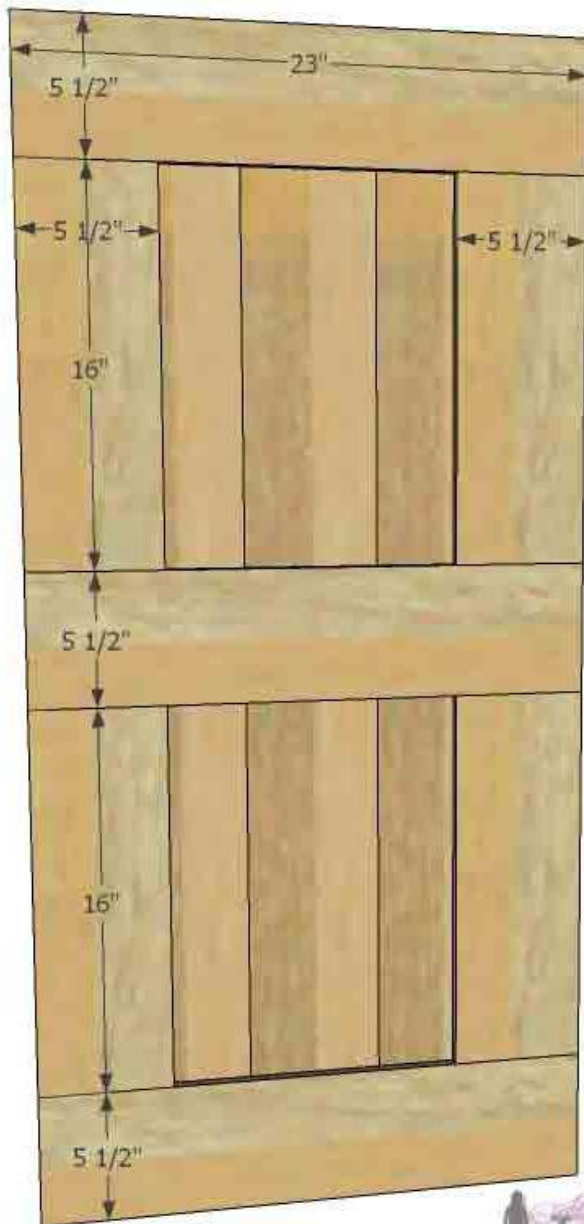

Build 2 flower boxes from cedar fence pickets; assemble the boxes with brad nails or 1 5/8" screws. You may want to drill holes in the bottom for drainage.

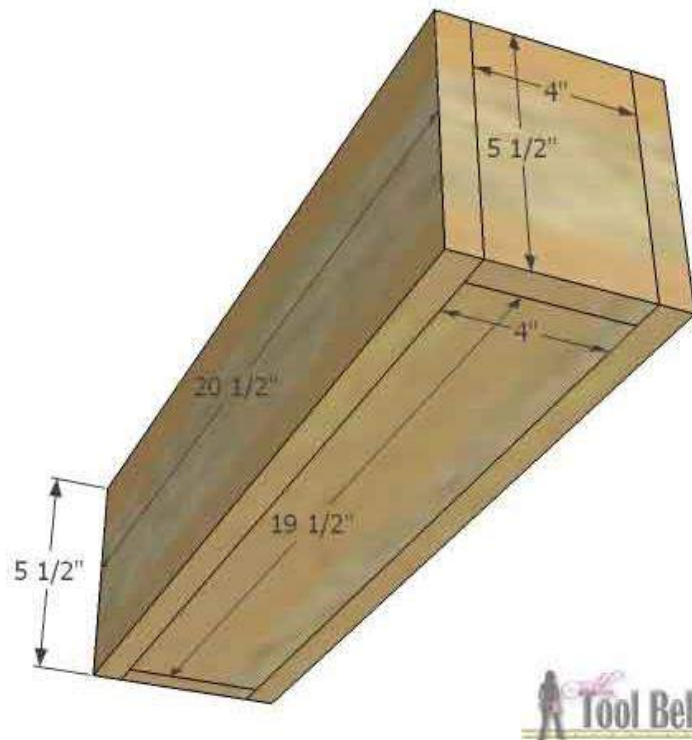

Build 2 shutters. Rip the fence pickets to 2 1/2" wide, cut 6 pieces that are 26" long and 4 at 8 1/2" long. Use brad nails to assemble the shutters. Attach the shutters to the playset with 1 5/8" screws. Install 34 1/2" wood counter top to the base of the large window, secure with 2 1/2" screws.

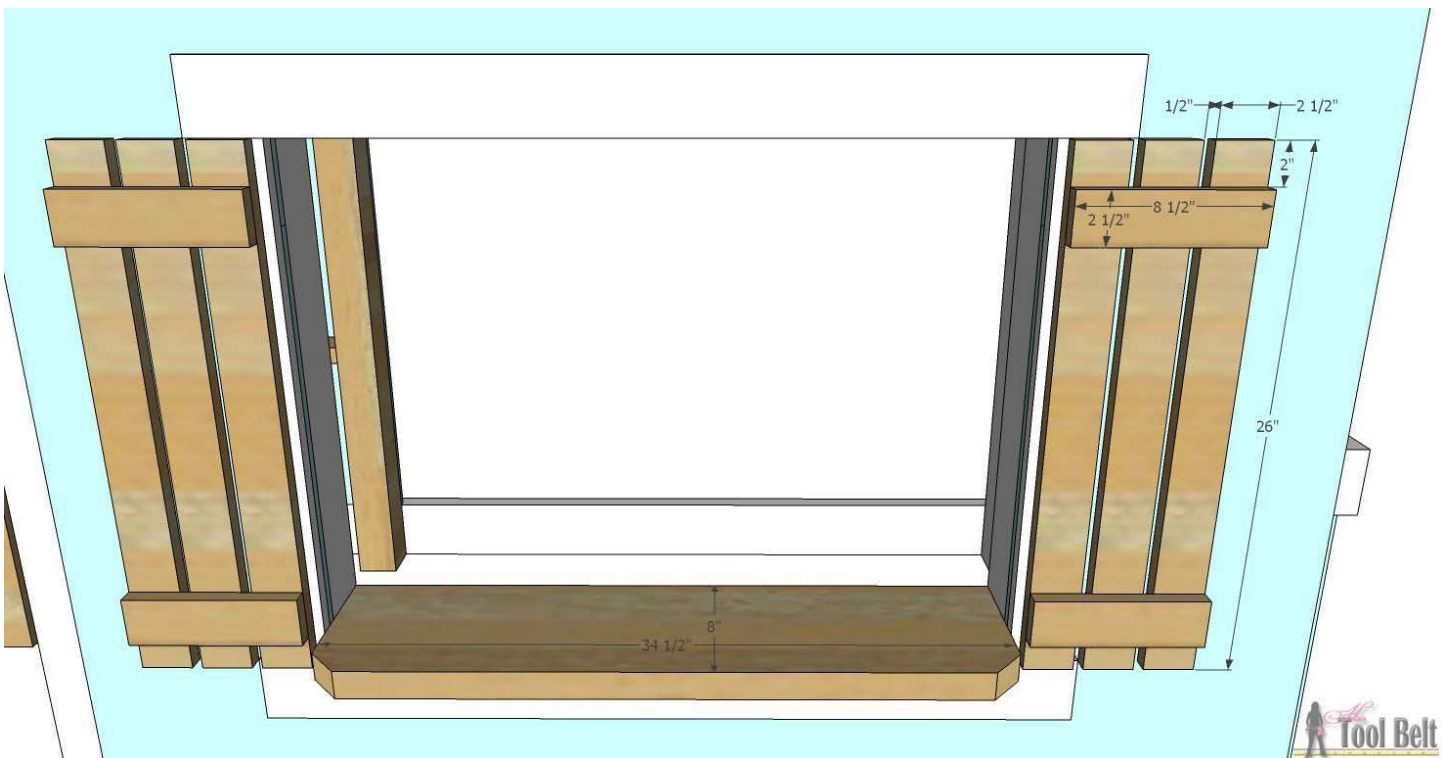

Step 14

Assemble the swing set according to the kit. The kit comes with the option to use a 8' beam for 2 swings or 10' beam for 3 swings. The kit comes with 2 swings, but hardware for a third.

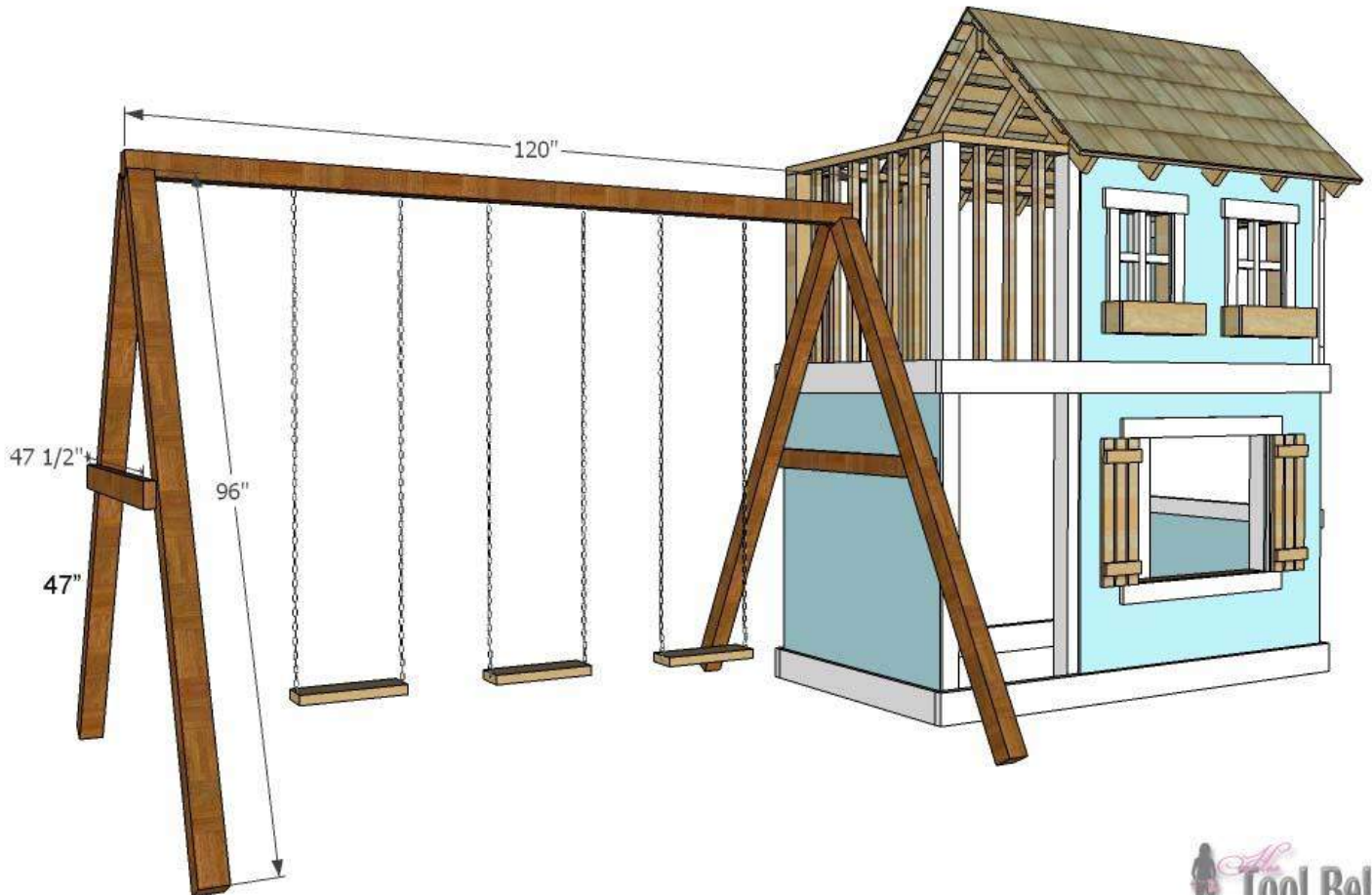

Step 15

To finish the playset, lightly sand the wood and prepare for paint or stain depending on your look. I primed and painted the playhouse. Make sure to seal the raw wood to help preserve it.

Attach the 5 foot slide, steering wheel and telescope.

Enjoy your DIY Playset!